

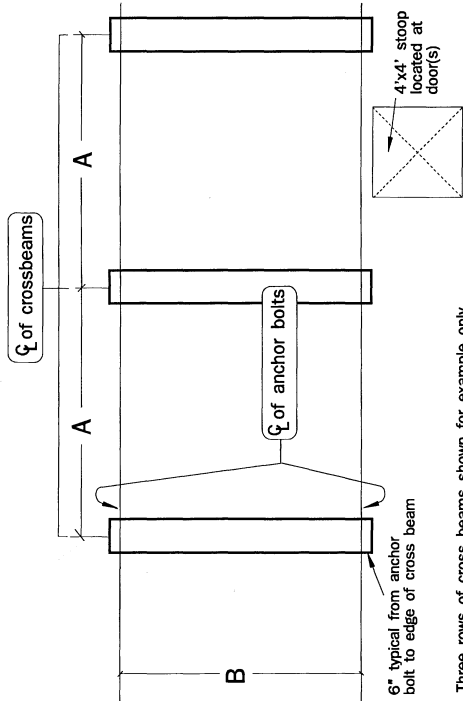

CROSS BEAM FOUNDATION PLAN



Three rows of cross beams shown for example only. Actual number of rows varies from two to eight depending on length of shelter. See Foundation Schedule to determine correct number of cross beams.

FOOTING

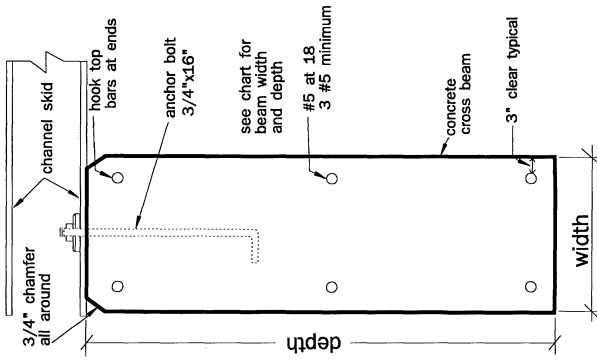

BOLTED CONNECTION TO SKIDS

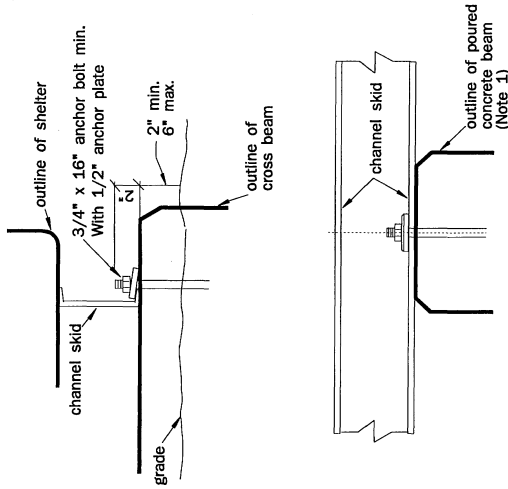

Foundation Schedule

Shelter length	Dimensions			
	8' or 10' wide shelters		12' wide shelters	
Rows of beams	A	B	A	B
8' (2)	6'-0"	7'-6"		
10' (2)	8'-0"	7'-6"		
12' (2)	10'-0"	7'-6"	10'-0"	11'-4"
14' (3)	6'-0"	7'-6"	6'-0"	11'-4"
16' (4)	4'-8"	7'-6"	4'-8"	11'-4"
18' (4)	5'-4"	7'-6"	5'-4"	11'-4"
20' (4)	6'-0"	7'-6"	6'-0"	11'-4"
22' (5)	5'-0"	7'-6"	5'-0"	11'-4"
24' (5)	5'-6"	7'-6"	5'-6"	11'-4"
26' (5)	6'-0"	7'-6"	6'-0"	11'-4"
28' (6)	5'-2-3/8"	7'-6"	5'-2-3/8"	11'-4"
30' (6)	5'-7-1/4"	7'-6"	5'-7-1/4"	11'-4"
32' (6)	6'-0"	7'-6"	6'-0"	11'-4"
34' (7)	5'-4"	7'-6"	5'-4"	11'-4"
36' (7)	5'-8"	7'-6"	5'-8"	11'-4"
38' (7)	6'-0"	7'-6"	6'-0"	11'-4"
40' (8)	5'-5-1/8"	7'-6"	5'-5-1/8"	11'-4"

Cross Beam Foundation Allowable snow and wind loads

Beam Width	1'-0"	1'-6"	2'-0"	2'-6"	3'-0"
Beam Depth	3'-6"	3'-6"	4'-0"	5'-0"	6'-0"
Ve (MPH)	100	115	130	160	170

Ve = effective wind speed, mph.

Notes

1. Top of foundation must be level to within 1/8".
2. Soil conditions must be verified by a local soils consultant prior to installation.
3. Beams must extend below frost line.
4. Foundation designs are based on maximum 25PSF floor live load occurring simultaneously with either maximum wind or snow loads.
5. Foundations shown are based on net allowable soil bearing pressure of 2000 PLF.

ROHN

Standard ROHN Fiberglass Equipment Shelter foundation plan and details

Scale For reference only Date

Drawn by JHW

Checked By CLP

91-2605SR1

Copyright 1993 ROHN

This drawing is the property of ROHN. It may not be reproduced, copied or traced in whole or in any part without our written permission. Specifications subject to change without notice.